



Cerberus® AlgoRex

Automatic fire detectors

Collective

DO1100
DT1100

-
- **High degree of reliability and stability**
 - **Comprehensive final examination and quality control**
 - **High resistance to:**
 - **electromagnetic interference**
 - **humidity and corrosion**
 - **Modern design**
 - **Blends well with every room decor**
 - **Compatible with all Cerberus control units with collective detector evaluation**
 - **Environmentally safe material:**
 - **halogen-free plastic material identifiable through embossed code**
 - **easy to uninstall and disassemble**

Wide spectrum smoke detector DO1100 Series

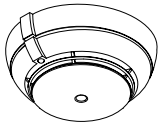

- **Uniform response behaviour for different types of fire**
- **New, high performance optoelectronic sensor system**
- **High resistance to soiling and temperature fluctuation**

Application

DO1101A

For the early warning of smoke-forming flaming fires and smouldering fires.

DO1103A

With considerably higher response sensitivity for use in air sampling smoke detection systems.

DO1104A

With higher response sensitivity for the early warning of smoke-forming flaming fires and smouldering fires.

For applications in hospital rooms, archives, museums, etc.

Functions

Danger signal. Penetrating smoke scatters the light of an infrared beam in the detector. If the light scatter exceeds a certain value, the detector transmits a danger signal to the control unit.

Built-in response indicator provides on-site signalling of alarm.

Heat detector DT1100 Series

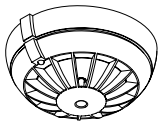

- **Precise maximum temperature alarm activation with quality thermosensor**
- **Response behaviour immune to deceptive phenomena with rapid and slow increases in temperature**
- **Intelligently designed differential characteristics**
- **DT1101A: Class 1 heat detector with wide application range (up to +50°C)**
- **DT1102A: Heat detector for high ambient temperatures (up to +70°C)**

Application

DT1101A

For the monitoring of rooms and installations where in the event of fire, a rapid increase in temperature can be expected, or other types of detector cannot be used due to operational reasons.

DT1102A

For the monitoring of rooms and installations in which high ambient temperatures can be expected (up to +70°C).

Functions

Danger signal. The detectors measure the ambient temperature with one NTC thermistor and the detector housing temperature with another NTC thermistor. In this way the detectors can rapidly and differentially evaluate an increase in temperature independent of the starting temperature. Upon exceeding the specified threshold value or upon exceeding the corresponding maximum temperature, the detectors transmit a danger signal to the control unit.

Built-in response indicator provides on-site signalling of alarm.

Installation

Mounting with detector base DB1101A.
Range of base accessories for installation even in critical locations.
Connection to the control unit via a two-wire line.
Vibration-proof mounting of detector in the base.
Anti-theft device can be built in if required.
Two external response indicators can be connected.

Maintenance

DO1101A, DO1104A, DT1100 Detectors can be inserted and removed from their bases with a detector exchanger up to a height of 7m.

DO1100 By means of a periodic factory overhaul (cleaning and re-calibration), smoke detectors are given a new lease of life.

Dimensions

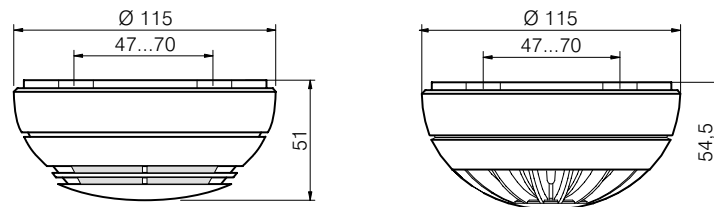

Series DO1100 with
DB1101A base

Series DT1100 with
DB1101A base

Technical data

	DO1101A DO1104A	DO1103A	DT1101A	DT1102A
Operating voltage	16...26VDC	16...26VDC	16...26VDC	16...26VDC
Operating current (quiescent)	max. 100µA	max. 100µA	max. 100µA	max. 100µA
Operating temperature	-25...+60°C	-25...+60°C	-25...+50°C	-25...+70°C
Humidity, ≤34°C >34°C	≤95% r.h. ≤35g/m ³	≤95% r.h. ≤35g/m ³	≤100% r.h. ≤35g/m ³	≤100% r.h. ≤35g/m ³
Protection category	IP44	IP44	IP44	IP44
Colour	white, ≈ RAL9010	white, ≈ RAL9010	white, ≈ RAL9010	white, ≈ RAL9010
Standards	EN54-7/9	-	EN54-5 Response grade 1	EN54-8 Temperature range 1 prEN54-5/BS
Approvals - VdS	DO1101A G294005	-	DT1101A G294017	DT1102A G294018
Compatibility	Compatible with all Cerberus control units with collective detector evaluation			
QS standards	Fire protection industry certified quality assurance system according to ISO9002, EN29002			

Details for ordering

Type	Part no	Designation	Weight
DO1101A	493002	Wide spectrum smoke detector, normal sensitivity	0.160kg
DO1103A	494580	Wide spectrum smoke detector for air sampling smoke detection systems	0.160kg
DO1104A	509064	Wide spectrum smoke detector, higher sensitivity	0.160kg
DT1101A	493170	Heat detector with differential characteristics	0.140kg
DT1102A	493183	Heat detector with maximum temperature actuation	0.140kg
DB1101A	486365	Base, collective	0.055kg

For base accessories see sheet DB11..., e1035

